

E

EXT6PT0005G2.5WXXX



Please refer to BS 7671, current rev for installation guidance

Name:	Evo Extender Lead
Type:	EXT6PT0005G2.5WXXX
Description:	Evo Extender Lead for Lighting circuits, 5 core x 2.5mm ² LSOH cable. Wiring standard 6PT.

Dimensions:

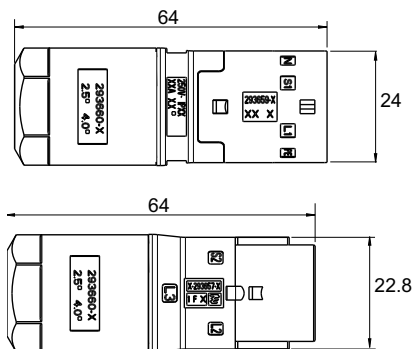

TECHNICAL SPECIFICATION

Material - Connector:	PA66 + 25%GF UL-94 V0 (S/N 704872-1) PA66 unfilled UL-94 V2 (S/N 1573372-1)
Cable type:	RZ1(05X21-R300/500V) BASEC CAD - CPR COMPLIANT DOP
Cable insulation:	XLPE (type GP 8 to BS 7655-1.3)
Fire requirements:	BS EN 50575:2014+A1:2016
Cable colour:	White
Minimum operating temperature:	-20°C
Maximum operating temperature:	+70°C
Enclosure class:	IP40 when engaged
Rated current (A):	20A
Power outputs (A):	5 Pole
Rated voltage (V):	240V
Frequency (Hz):	50Hz
Wire size (mm²):	2.5mm
Connector coupler standard:	IEC 61535:2009+A1:2013
QMS:	ISO 9001:2016
Wiring and test standard:	BS 8488:2009+A1:2010